

PAR



Image: Labtop

Setup as a platform for exchange, PAR translates an ongoing effort of spatial and cultural analysis into building form. This year we've been involved with projects in North America, Europe, Asia and South America. We like to keep you informed - hereby our year end newsletter.

RECENT

PAR in collaboration with **SES, RLA** and **Buro Happold** were awarded honorable mention in the international competition for the **Keelung Harbor Port Terminal** in Keelung, Taiwan. A gateway to the nation, the 120,000 m² project is comprised of a ferry terminal and 70 meter office tower. (image above shows the entrance from Zhongshan Road)



Image: Labtop

Earlier this Fall, **PAR** along with engineering partner **ARUP**, presented Extreme Ocularity at the **Chicago Facade + Innovation Conference**. The presentation featured our approach to designing a high performance facade for a zero carbon building in the challenging climate of **Helsinki, Finland**.



Our design for a 15 ha private equestrian ranch in **José Ignacio, Uruguay** will be presented during a site visit over the winter holiday. Set upon a plateau, 7 buildings integrated with the surrounding horizons are approached by a processional on axis with the sea. Taking inspiration from Le Corbusier's masterwork Ronchamp, punctuated thick masonry walls amplify light and sound.

PUBLICATIONS



Mark, #41, Dec/Jan 2012-13
Future Arquitecturas, 33-34
Concept, Vol. 163, 11-2012
Competitions, Winter 2012

EXHIBITIONS

The Archipelago, a proposal for 400 houses in Leeuwarden, NL was honored with a **AIA National Emerging Architecture Award** and an **AIA Next LA Honor Award**. The project was exhibited at the **American Institute of Architects 2012 National Convention**.

PAR's finalist proposal for the **Keelung Harbor Competition** was up for exhibition in Taiwan alongside entries from **NMDA**, **Asymptote**, **Mecanoo** and **ACDF**. The opening took place September 20th through 27th of November.

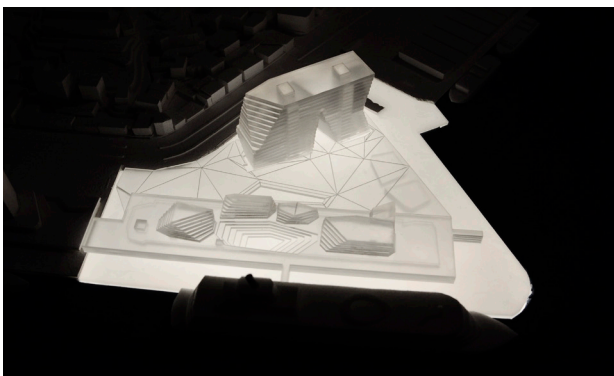

Image: RLA

ON THE RADAR



We have been working on 2 museum proposals which are still in judging procedure. **For the Cagliari Galerie Comunale D'Art**, **PAR** designed a network of separate but interconnected galleries that unfold and open into the landscape. Simple, primitive forms and local materials reflect a Sardinian sensibility, while the gesture of breaking up the museum into discreet volumes transforms the cluster of galleries into an architecture that is at once contextual and abstract.

In **Athens**, we developed together with engineering partner **ARUP**, the adaptation of a 14.000 m² former grain silo into a **Museum of Underwater Antiquities**. A system of void spaces introduces a spatial configuration that brings daylight to public areas whilst engaging the surrounding urban context. At moments of subtraction, the cartesian grid of the silo building translates into a newly contoured geometry, expressing the old within the new.

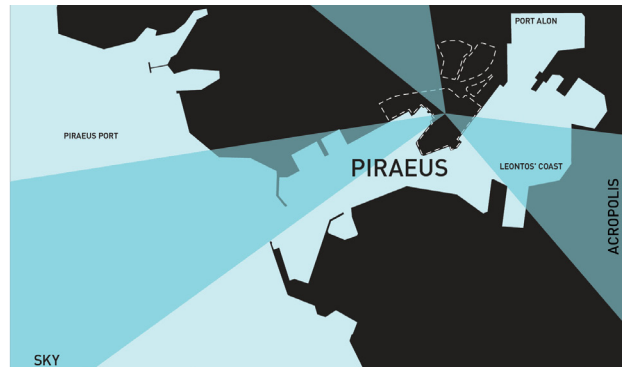

IN THE OFFICE

- We welcome to **PAR** **Lan Chen**, **Devon Montminy**, **Jesus De Anda** and **Anabelle Del Valle**.

- **PAR** celebrated the groundbreaking for a private house in Los Angeles on August 13, 2012. Terraced into a canyon near the hollywood sign, the **M House** is scheduled to top out in Summer 2013.

- Look out for **PAR's** new website designed by our friends at **2x4** in early 2013.



Image: Labtop